



ACD-2200

Four-channel Video Server with Two Way Audio



- Selectable MPEG-4 SP / MJPEG compression
- CIF up to Full D1 resolution at 30/25 FPS
- Multi-stream with variable frame rate in the same compression
- Two way audio supported (per channel)
- Hardware motion detection, Digital Input / Output (per channel)
- Serial ports for each channel

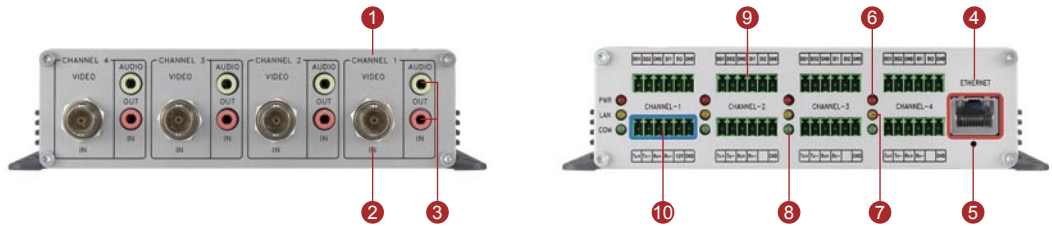

- | | | | |
|----------------------|------------------------|-----------------|------------------------------------|
| ① Channel Number | ③ Audio Input / Output | ④ Ethernet Port | ⑧ RS-485 LED |
| ② Analog Video Input | | ⑤ Reset Button | ⑨ Digital Input / Output |
| | | ⑥ Power LED | ⑩ Serial Port & DC 12V Power Input |
| | | ⑦ LAN LED | |

DIMENSION DIAGRAM

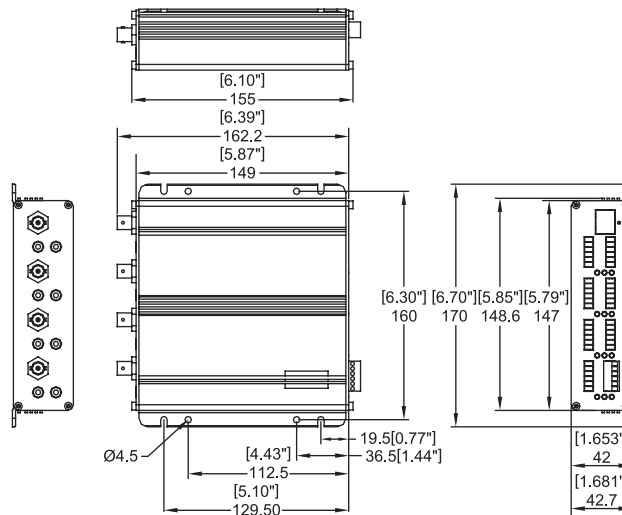

Unit: mm [inch]

**PRODUCT SPECIFICATION****Video Compression**

Compression	MPEG-4 SP, MJPEG selectable
Picture Resolution	Full D1 (720 x 480 in NTSC, 720 x 576 in PAL) VGA (640 x 480 in NTSC, 640 x 480 in PAL) CIF (352 x 240 in NTSC, 352 x 288 in PAL) QCIF (160 x 112 in NTSC, 176 x 144 in PAL) (per channel)
Bit Rate	28K ~ 3M bps (per channel)
Image Frame Rate	30fps at full D1 resolution (NTSC) 25fps at full D1 resolution (PAL) (per channel)
Multi-stream	Up to 2 configurable frame rate/bit rate streams for preview and recording (per channel)

Function

Motion Detection	Yes
------------------	-----

Video Input

Composite Input	4, CVBS, 1.0Vp-p with 75 Ω loading, BNC Connector
-----------------	--

Audio Input

Compression	8 kHz, Mono, PCM
Audio Line Input	4, Unbalanced, 1.4 Vp-p, 1Vrms, 3.5 mm Phone Jack (per channel)

Audio Output

Compression	8 kHz, Mono, PCM
Audio Line Output	4, Unbalanced, 1.4 Vp-p, 1Vrms, 3.5 mm Phone Jack (per channel)

Alarm

Digital Input	2, TTL, terminal block (per channel)
Digital Output	2, TTL, terminal block (per channel)

Remote Control

Serial Port	RS-485: half duplex, terminal block RS-422: full duplex, terminal block RS-232**: full duplex, terminal block (per channel)
-------------	--

External I/O

Reset Button	Factory default
LED	System status (per channel)

Network

Ethernet Port	Ethernet (10/100 Base-T), RJ-45 connector
Protocol	TCP, UDP, HTTP, HTTPS, DHCP, PPPoE, RTP, RTSP, DNS, DDNS, NTP, ICMP, ARP, IGMP, SMTP, FTP, UPnP

Software

Web Browser	Microsoft Internet Explorer 6.0 or above
SDK	ACTi SDK-10000

PTZ Protocol*	Pelco-D, Pelco-P V1 and V2, Dynacolor, Sony VISCA, American Dynamics
---------------	---

Security	Password protection: configured by the administrator
----------	---

Operating

Temperature	0 °C ~ 40 °C (32 °F ~ 104 °F)
-------------	-------------------------------

Power

Power Requirement	DC 12V ±10%
Power Consumption	16 W

Physical

Dimensions (WxHxD)	170 mm x 42.7 mm x 149 mm (6.70" x 1.68" x 5.87")
Weight	820 g (1.80 lb)

Approvals

Certificate	CE, FCC
-------------	---------

* These PTZ protocols are supported in ACTi NVR and Streaming Explorer.

** Adjust by inside jumper.